

Existing Apartment
Second Floor
 605 sf SC: 1/4" = 1'-0"

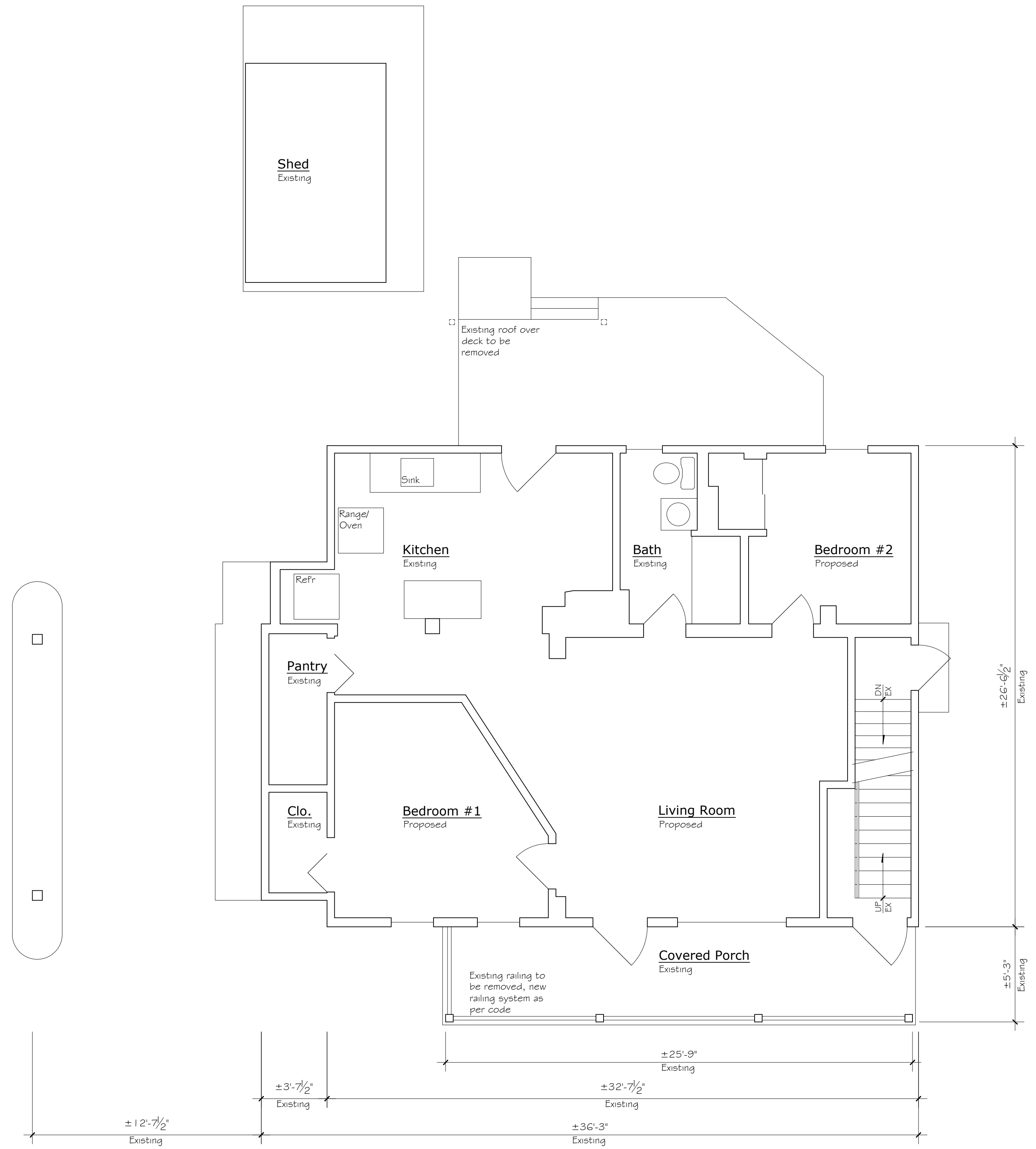

Proposed Apartment
First Floor
 930 sf SC: 1/4" = 1'-0"

CONSULTANTS

PROJECT Planning Board Drawings for:
2475 Lamington Rd LLC
 2475 Lamington Road
 Bedminster, New Jersey 07921

JOSEPH M MARCHESE
 ARCHITECT
 P.O. Box 184 Kenil, NJ 07847
 PH: 973-252-7746 FX: 973-252-7747
 JMMARCHESOPROFONLINE.NET

SEAL *[Signature]*
 NJ LIC. 21A01487100

REVISIONS
 29 Apr 23 Review
 12 May 23 Review
 05 Jun 23 Planning Bd

DATE
 DRAWN BY JMM
 JOB NO. 2303